



Günli Yazılım ve Mühendislik A.Ş.

GNL CAD/CAM SDK

G-CNC-Libv1.0

We are a team dedicated to ensuring your operation runs with ever greater efficiency.





GNL CAD/CAM SDK

G-CNC-Libv1.0



- It is developed to calculate 2D and 2.5D CAM operations.
- It supports operations such as Plotting, Profiling, Face Milling, Drilling, Pocketing, and Text operations.
- It features an event-based post-processing engine.
- Can generate GCode output.
- Developed in DLL format using a C-type function structure.
- It is compatible with various programming languages including C#, Java, C, C++, PHP, Python, and more.

GNL CAD/CAM SDK Operations

Pocketing Operation

By analyzing the geometry with pocketing, we can employ two different methods for calculating the toolpath: parallel and offset. Additionally, we can perform a more detailed calculation by segmenting the geometry into slices based on specific heights.

Plotting Operation

It utilizes the given geometry as the cutting path, calculates the saw axis, and can segment the geometry into slices based on specified heights.

Profiling Operation

During the calculation of the toolpath, we consider whether to traverse the geometry from the inside or outside. In this process, we also account for the saw axis and segment the geometry into slices based on specific heights. This enables us to compute a precise and efficient toolpath.

[Go to Our Website](#)

Software Kernel for Toolpath Calculation for CNC Machines

[Go to Our Website](#)

Drilling

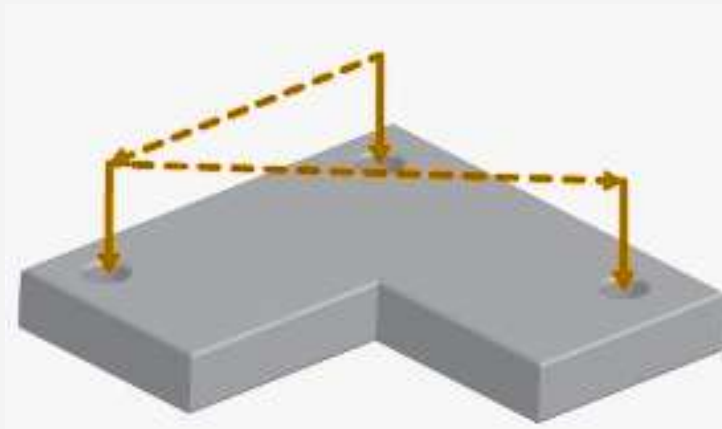

Face Milling

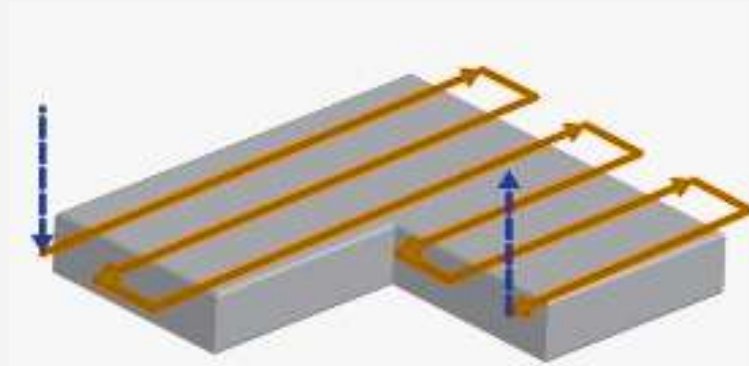

Plotting

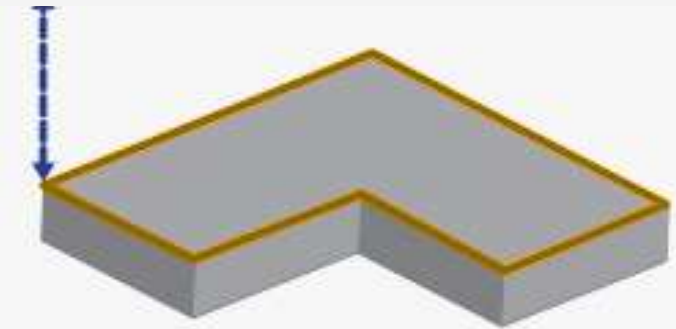

Profiling

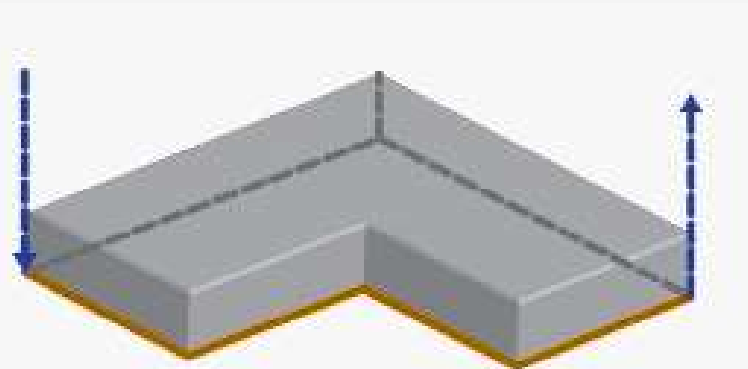

Roughing

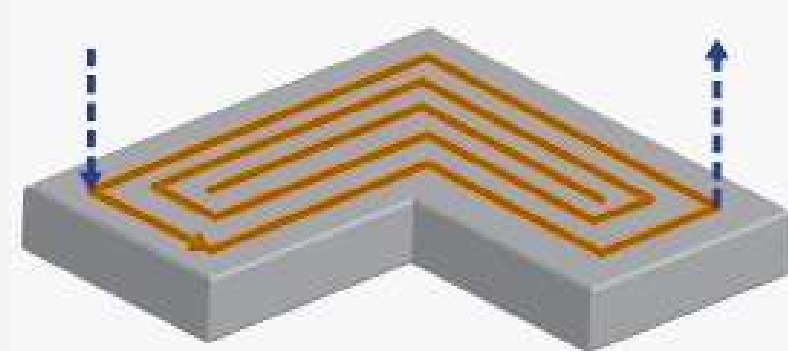

Profiling

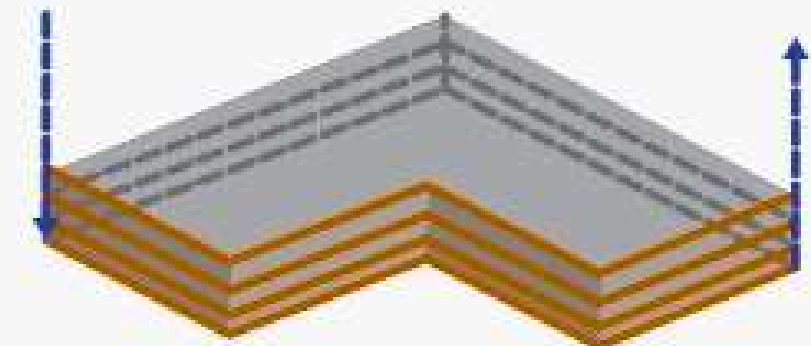

Have a question?

Feel free to get in touch!



Günili Yazılım ve Mühendislik A.Ş.



Sanayi Mah. Teknopark Bulvarı No: 1/1C, D:1503,
34906 Pendik



info@gunili.com



[0507 991 74 39](tel:0507 991 74 39)

[Go to Our Website](#)



[Facebook Link](#)



[Instagram Link](#)



[LinkedIn Link](#)



[Youtube Channel](#)